

Size Information

Universal Left/Right

Washing Instruction

Hand wash in cold water with mild soap, gentle cycle.

Rinse well and air dry.

Do not dry clean or tumble clean; do not use bleach.

Do not expose this brace to any heat source. Remove metal splint or hinge prior to washing.

Caution

If allergic skin rashes or discomfort increases, please consult your physicians.

Indication

For uni-compartment OA patient
Mild to moderate OA knee user

Contraindication

Paraesthesia
Severe varicose vein
Skin disorders or injuries in the relevant area
Impaired lymphatic drainage

Recommendation

These products are to be used only by those which have been medical specialist. In order to dispose of the product, comply with the legal norms of your country. If any serious incident that has occurred in relation to the device should be reported to the manufacturer and the competent authority of the Member State in which the user and/or patient is established.

Classification

Class I medical device, non sterile, no measurement function. This product fulfils the Medical Device Regulation (EU) 2017/745.

Manufactured By:

e-life International Co., Ltd.

Head Office:

7F, No.1, Baosheng Rd., Yonghe Dist., New Taipei City 234, Taiwan (R.O.C.)

Tel: +886-2-29231516

Fax: +886-2-29290783

E-mail: info@e-lifebracing.com

www.e-lifebracing.com

Made in China



e-life

Application Instruction

Telescopic OA Knee



2020 version 1

www.e-lifebracing.com

INSTRUCTIONS FOR USE

MKNOA08 Telescopic OA Knee

Application Instruction

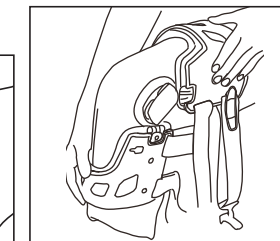
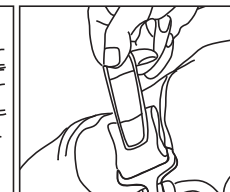
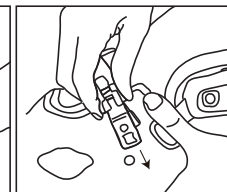
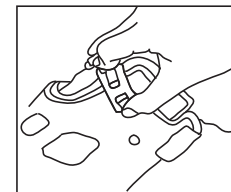

Detach all straps:

1. Release the buckle by pushing the button.
2. Slide the buckle out of the notch to detach.
3. Release each of the straps from the buckles, attach the strap to its most loosening setting from the buckle end if it is the first time to apply the brace.

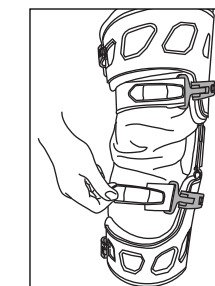
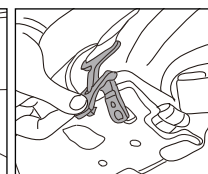
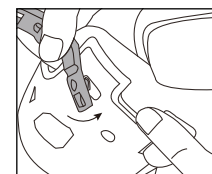

6. Press the shell against the leg and secure the straps, starting from upper thigh.
7. Plug the buckle into the notch and close the button. Adjust the strap length to desired fit.
8. Finish other three straps.

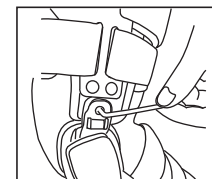

10. Adjust the knee valgus/varus angle with hex wrench for minor adjustments.

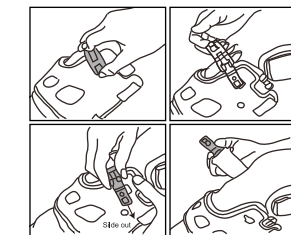

11. Once the strap length is adjusted, you may use quick release buckle to fasten and unfasten the brace.

How to set the ROM hinge

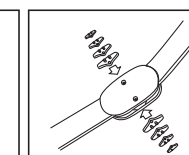
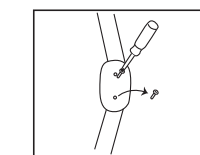

1. Use a screwdriver to remove screws for inserting flexion/ extension stops.
2. Take off the existing stop and insert new plug-in stops, which are desired flexion/extension degree.
3. Screw it back to ensure settings. Be sure both screws are sealed and snug.

How to adjust the length

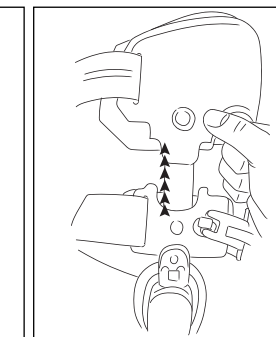
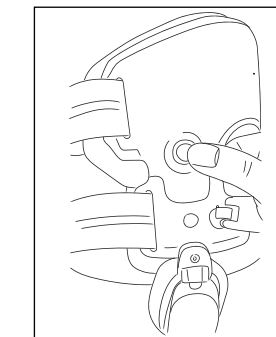

1. Press the length adjust button.
2. Extend the length.

Copyright ©2020 by e-life International Co., Ltd. All rights reserved.
Unauthorized duplication is a violation of law.